

TEXANA PLANTATION HOMEOWNERS ASSOCIATION, INC.
P.O. BOX 219223
HOUSTON, TEXAS 77218
281 870-0585 FAX 281-870-9170

RESOLUTION AND APPOINTMENT ADOPTED
BY UNANIMOUS WRITTEN CONSENT
OF BOARD OF DIRECTORS

The undersigned, being all of the Directors TEXANA PLANTATION HOMEOWNERS ASSOCIATION, INC. (Texana Plantation HOA) do, by these presents unanimously approve, ratify and adopt the following resolutions effective the 1st day of May, 2000.

RESOLVED, that the Board of Directors of Texana Plantation HOA does hereby accept and adopt the REVISED LANDSCAPE GUIDELINES, Revised 5.1.00 as approved and submitted by the Architectural Review Committee and attached hereto as Exhibit "A".

Executed and effective as of the date and year written above

Peyton L. Martin, President

Lloyd Knapp, Vice President

Lori Platt, Secretary/Treasurer

LANDSCAPING GUIDELINES

The following guidelines are minimal and supplemental to the Deed Restrictions and Builder Guidelines.

A Landscape Plan is required for each house. These guidelines are designed to assist in the preparation of that plan.

These guidelines consist of a Plant List (5 pages) and a series of sketches covering various situations concerning various types of lots and other landscape criteria.

These guidelines should be used in preparation of the Landscape Plan since they will be used by the Texana Plantation Architectural Review Committee during the review of the plan.

The guidelines included in this package are as follows:

Page 1	Introduction
Page 2-6	Plant List. Only plants on this list may be used.
Page 7	Lake Lots
Page 8	Greenbelt Lots
Page 9	Corner Lots
Page 10	Garage Landscaping
Page 11	Garage Door Screening
Page 12	Utility Screening
Page 13	Wood Fence
Page 14	Metal Fence
Page 15	Metal Fence Spear Points

INTRODUCTION

LANDSCAPE GUIDELINES
TEXANA PLANTATION

TEXANA PLANTATION - TREES

<i>Acacia farnesiana</i>	- Huisache
<i>Acer rubrum</i>	- Red Maple
<i>Acer saccharinum</i>	- Silver Maple
<i>Betula nigra</i>	- River Birch
<i>Carya illinoensis</i>	- Pecan "
<i>Cassia corymbosa</i>	- Cassia
<i>Ceris canadensis</i>	- Redbud
<i>Crataegus marshallii</i>	- Parsley Hawthorne
<i>Eriobotrya japonica</i>	- Loquat
<i>Gleditsia tridcanthos</i>	- Honeylocust
<i>Koelreutaria bipinnata</i>	- Goldenrain Tree
<i>Liquidambar styraciflua</i>	- Sweet Gum
<i>Magnolia spp.</i>	- All Species
<i>Nyssa sylvatica</i>	- Black Gum
<i>Parkinsonia aculeata</i>	- Retama
<i>Pistacia chinensis</i>	- Chinese Pistache
<i>Platanus</i>	- Sycamore (All Species)
<i>Prosopis glandulosa</i>	- Mesquite
<i>Prunus Mexicana</i>	- Mexican Plum
<i>Quercus</i>	- Oaks (All Species)
<i>Taxodium distichum</i>	- Bald Cypress
<i>Ulmus spp.</i>	- Elms
<i>Vitex agnuscastus</i>	- Vitex

PLANT LIST
LANDSCAPE GUIDELINES
TEXANA PLANTATION

TEXANA PLANTATION - SHRUBS

Abelia spp.	- All Varieties
Anisacanthus wrightii	- Hummingbird Bush
Berberis thunbergii	- Barberries
Buxus microphylla japonica	- Japanese Boxwood
Callicarpa americana	- American Beautyberry
Callistemon spp.	- Bottlebrush (all)
Camellia japonica	- Camellia
Cassia corymbosa	- Flowering Senna
Chaenomeles japonica	- Flowering Quince
Cortaderia selloana	- Pampas Grass
Cotoneaster spp.	- Cotoneaster
Cuphea hyssopiflora	- Mexican Heather
Eleagnus spp.	- Eleagnus
Feijoa soloniana	- Pineapple Guava
Gardenia spp.	- Gardenias
Hesperaloe parvifolia	- Red Yucca
Hibiscus spp.	- Hibiscus
Hypericum patulum henry	- St. Johns Wort
Ilex spp.	- All Varieties
Jasminum spp.	- All Varieties
Juniperus spp.	- All Junipers
Lagerstroemia indica	- Crepe Myrtles
Leucophyllum spp.	- Cenizo
Ligustrum spp.	- All Varieties
Loropetalum chinensis	- Loropetalum
Mahonia spp.	- Oregon Grape Hollies
Michelia figo	- Banana Shrub

PLANT LIST

LANDSCAPE GUIDELINES
TEXANA PLANTATION

TEXANA PLANTATION - SHRUBS (continued)	
<i>Myrica cerifera</i>	- Waxmyrtle
<i>Nandina domestica</i>	- All Varieties
<i>Nerium oleander</i>	- Oleander
<i>Pavonia lasiopetala</i>	- Rock Rose
<i>Philadelphus spp.</i>	- Mock Orange
<i>Photinia spp.</i>	- All Varieties
<i>Pittosporum spp.</i>	- All Varieties
<i>Plumbago auriculata</i>	- Plumbago
<i>Podocarpus macrophyllus</i>	- Yew
<i>Prunus caroliniana</i>	- Cherry Laurel
<i>Pyracantha spp.</i>	- Pyracanthas
<i>Raphiocepis indica</i>	- All Varieties
<i>Rhododendron spp.</i>	- Azaleas
<i>Rhus spp.</i>	- Sumac (All Varieties)
<i>Rosa spp.</i>	- Roses
<i>Sabal minor</i>	- Palmetto
<i>Sophora secundiflora</i>	- Mountain Laurel
<i>Spirea spp.</i>	- Spirea
<i>Tecoma stans</i>	- Yellow Belts
<i>Ternstroemia gymnanthera</i>	- Cleyera
<i>Viburnum spp.</i>	- Viburnum
<i>Viguiera stenoloba</i>	- Golden Eye
<i>Yucca spp.</i>	- Yucca

PLANT LIST

LANDSCAPE GUIDELINES
TEXANA PLANTATION

**TEXANA PLANTATION
GROUNDCOVERS - VINES**

<i>Agapanthus africanus</i>	- Agapanthus
<i>Ajuga</i> spp.	- Ajuga
<i>Antigonon leptopus</i>	- Coral Vine
<i>Asparagus</i> sp.	- Asparagus Fern
<i>Aspidistra elatior</i>	- Cast Iron Plant
<i>Aquilegia canadensis</i>	- Columbine
<i>Bignonia capreolata</i>	- Cross Vine
<i>Campsis</i> spp.	- Trumpet Creeper
<i>Chrysactinia Mexicana</i>	- Damianita
<i>Clematis texensis</i>	- Clematis
<i>Cytomium falcatum</i>	- Holly Fern
<i>Evolvulus nuttallianus</i>	- Blue Daze
<i>Ficus pumila</i>	- Climbing Fig
<i>Gelsemium sempervirens</i>	- Carolina Jessamine
<i>Hedera helix</i>	- English Ivy
<i>Hemerocallis</i> spp.	- Daylily
<i>Hibiscus coccineus</i>	- Texas Star Hibiscus
<i>Iris brevicaulis</i>	- Louisiana Iris
<i>Lantana</i> spp.	- Lantana
<i>Liriope</i> spp.	- Liriope
<i>Lonicera</i> spp.	- Honeysuckle
<i>Moraea iridoides</i>	- Butterfly Iris
<i>Ophiopogon japonicus</i>	- Monkey Grass
<i>Parthenocissus quinquefolia</i>	- Virginia Creeper
<i>Ruellia</i> spp.	- Ruellia
<i>Salvia</i> spp.	- All Varieties
<i>Scutellaria suffrutescens</i>	- Pink Skullcap
<i>Trachelospermum</i> spp.	- Star Jasmine Varieties
<i>Verbena</i> spp.	- All Varieties
<i>Vinca</i> spp.	- Periwinkle
<i>Wisteria sinensis</i>	- Wisteria

PLANT LIST
LANDSCAPE GUIDELINES
TEXANA PLANTATION

TEXANA PLANTATION - GRASSES

<i>Bouteloua gracilis</i>	- Blue Grass
<i>Cymbopogon citratus</i>	- Lemon Grass
<i>Cynodon dactylon</i>	- Bermuda Grass
<i>Dasyliion texana</i>	- Sotol
<i>Miscanthus</i> spp.	- Miscanthus
<i>Muhlenbergia</i> spp.	- Muhly Grass
<i>Molina</i> spp.	- Nolin
<i>Panicum virgatum</i>	- Switch Grass
<i>Pennisetum</i> spp.	- Fountain Grass
<i>Schizachyrium scoparium</i>	- Little Bluestem
<i>Sorghastrum nutans</i>	- Indian Grass
<i>Stenotaphrum secundatum</i>	- St. Augustine Grass
<i>Zoysia</i> spp.	- Zoysia Grass

PLANT LIST
LANDSCAPE GUIDELINES
TEXANA PLANTATION

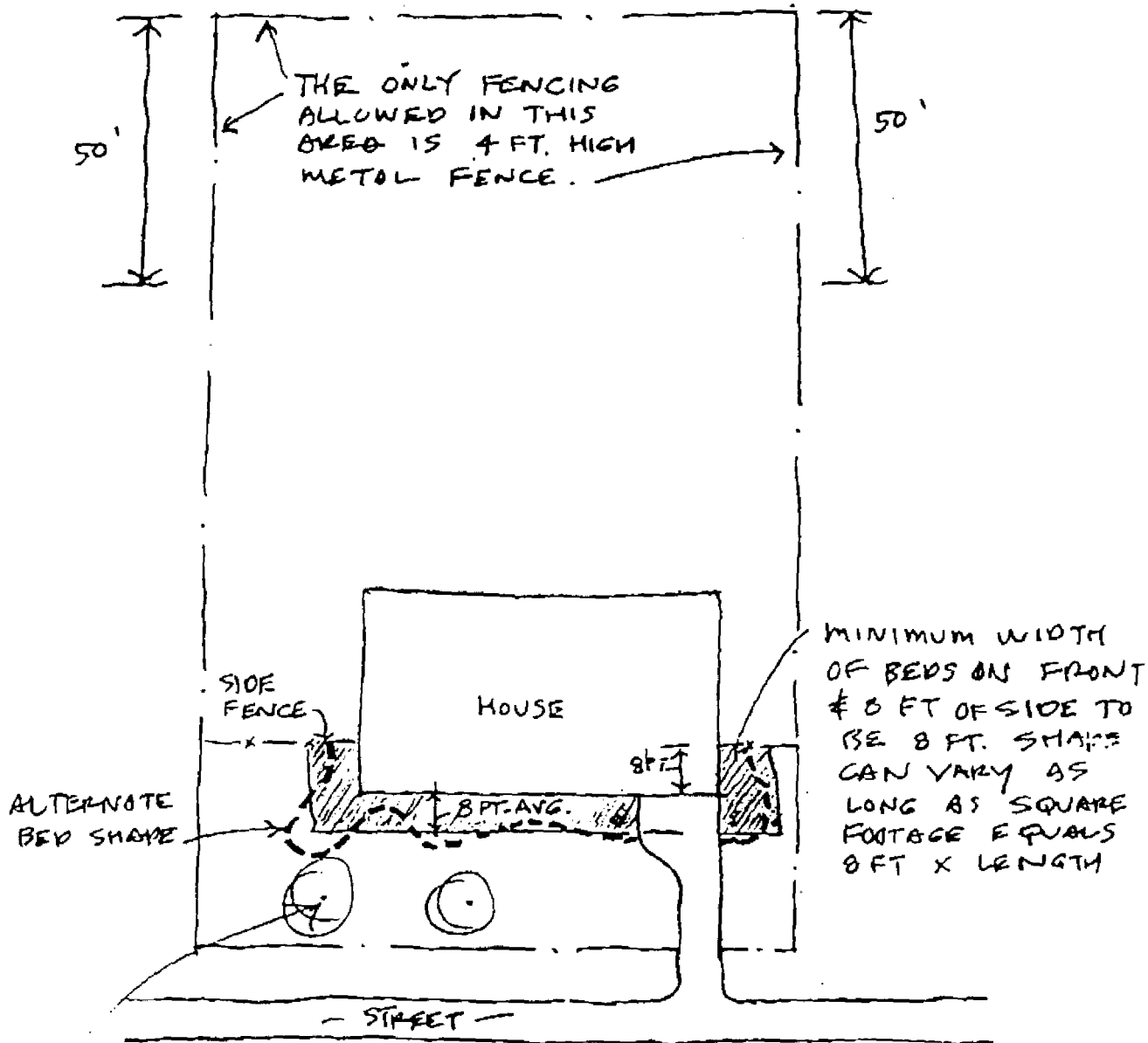

4 TREES PER LOT REQUIRED
 (MINIMUM CALIPER
 3 1/2" MEASURED
 12" ABOVE GROUND)
 AT LEAST TWO IN
 FRONT YARD

LAKE LOTS

LANDSCAPE GUIDELINES
 TEXAS PLANTATION

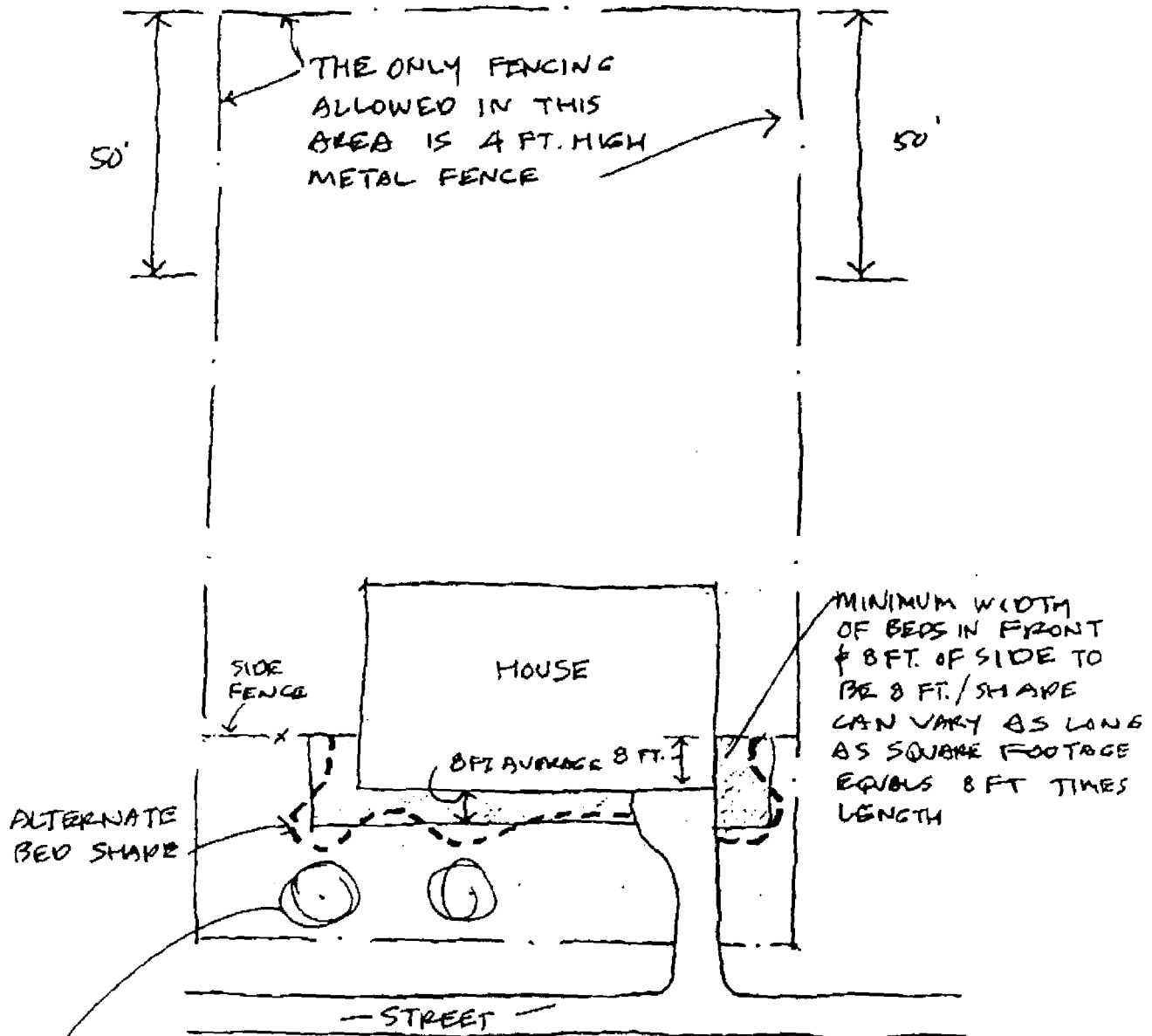

4 TREES PER LOT REQUIRED
 (MINIMUM CALIPER 3 1/2"
 MEASURED 12" ABOVE
 GROUND) AT LEAST TWO
 TREES IN FRONT YARD.

GREENBELT LOTS
LANDSCAPE GUIDELINES
TEXANA PLANTATION

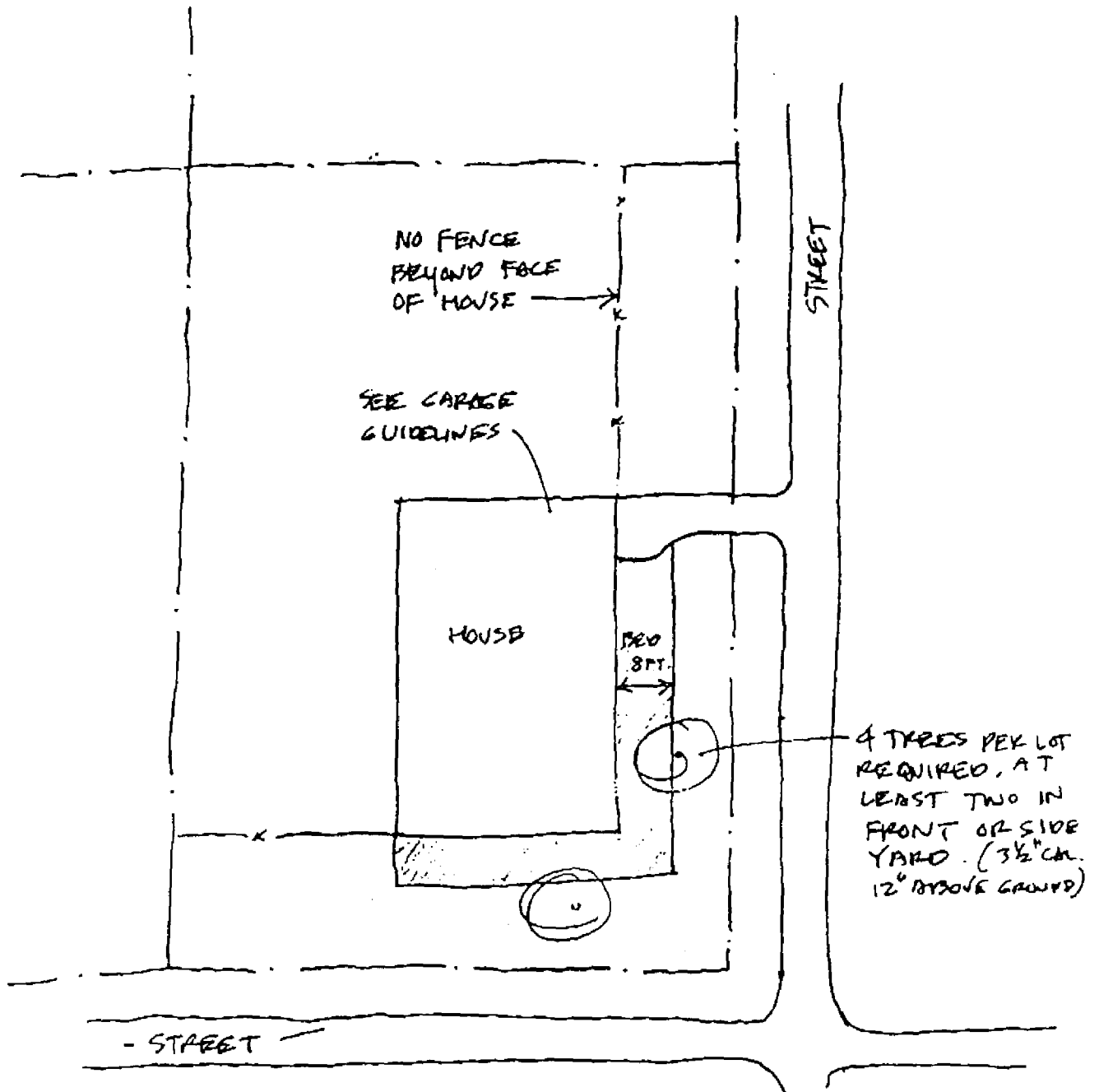

CORNER LOTS
 LANDSCAPE GUIDELINES
 TEXANA PLANTATION

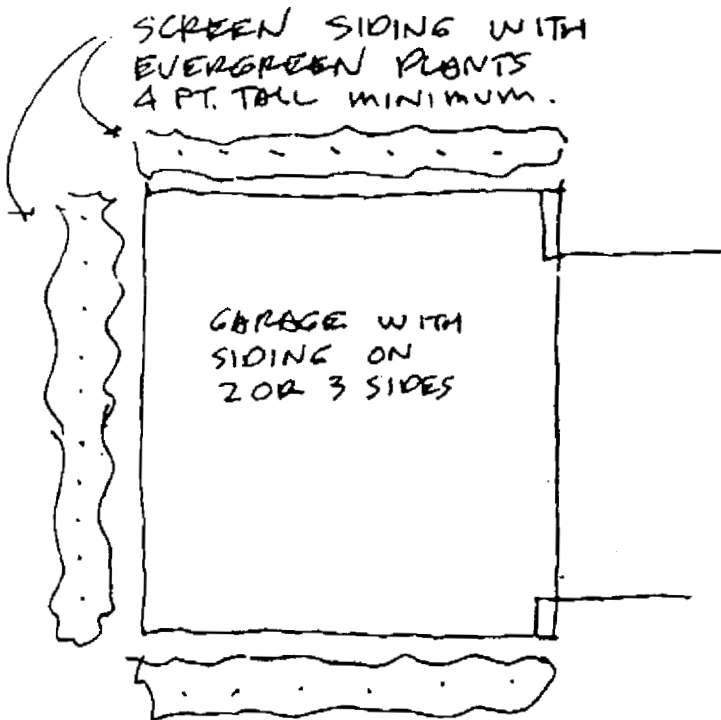
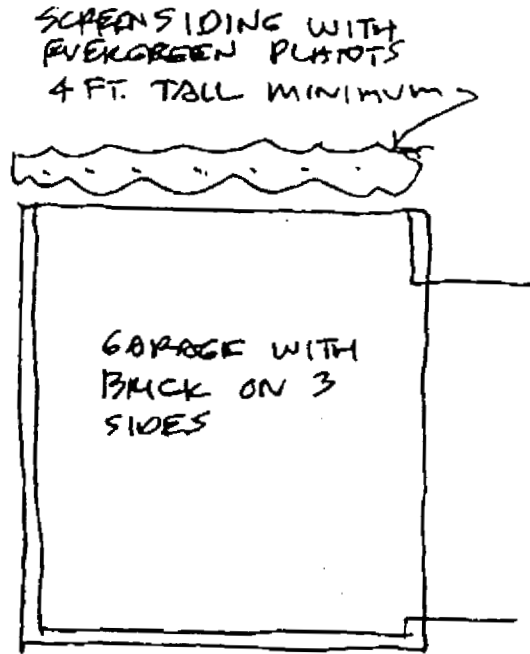
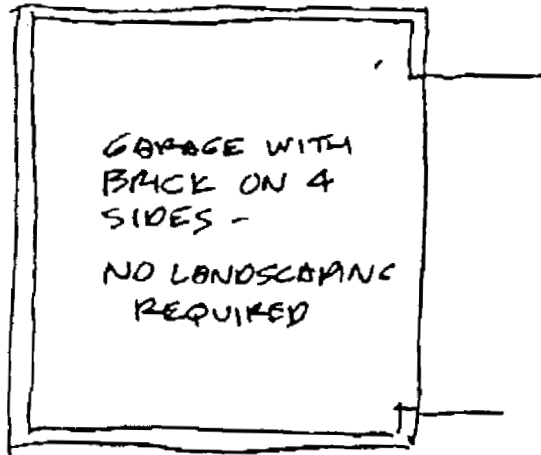

DETACHED GARAGES
LANDSCAPE GUIDELINES
TEXAS PLANTATION

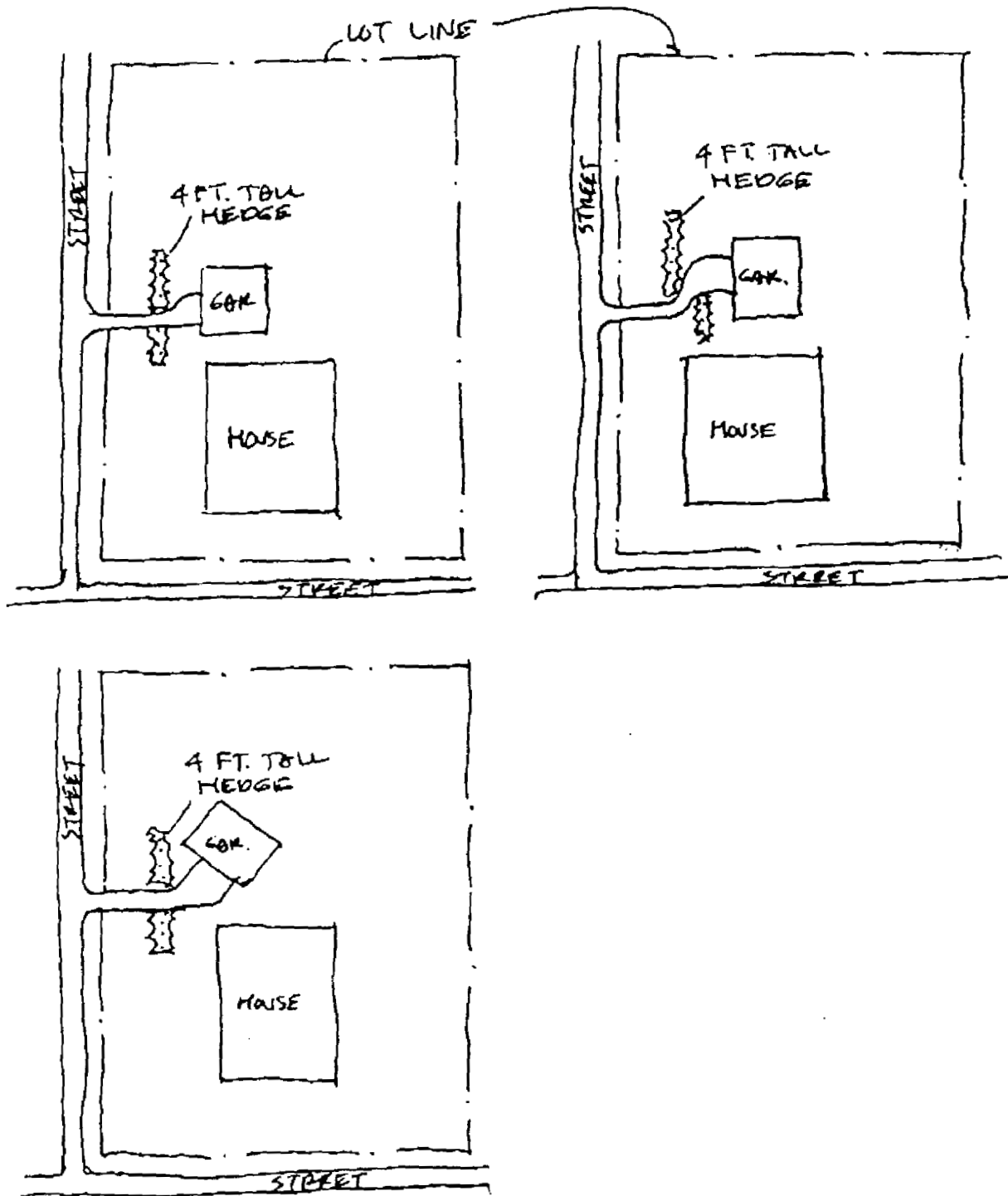

GARAGE DOOR SCREENING
 LANDSCAPE GUIDELINES
 TEXONA PLANTATION

SCREEN ALL VIEWS FROM
PUBLIC STREETS, GREENBELTS,
LAKES ETC. SHRUBS TO BE
12" ABOVE TOP OF UTILITY.

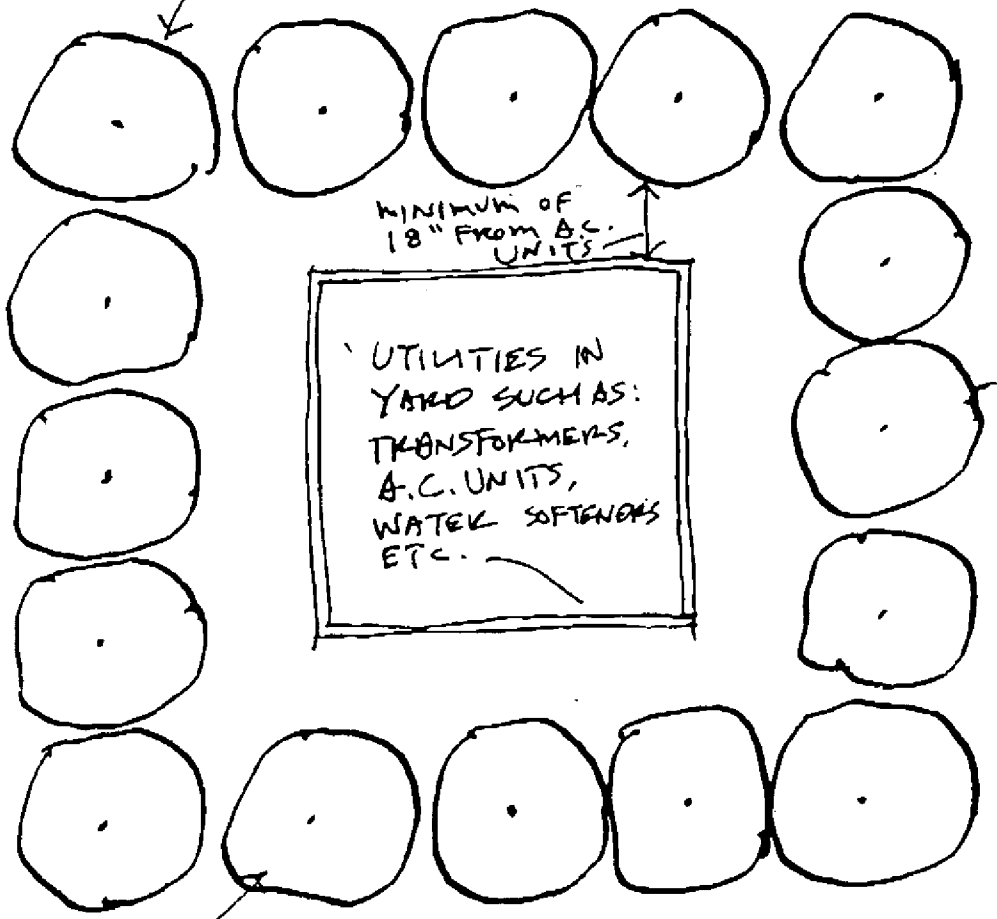

EVERGREEN
SHRUBS

UTILITY SCREENING
LANDSCAPE GUIDELINES
TEXANA PLANTATION

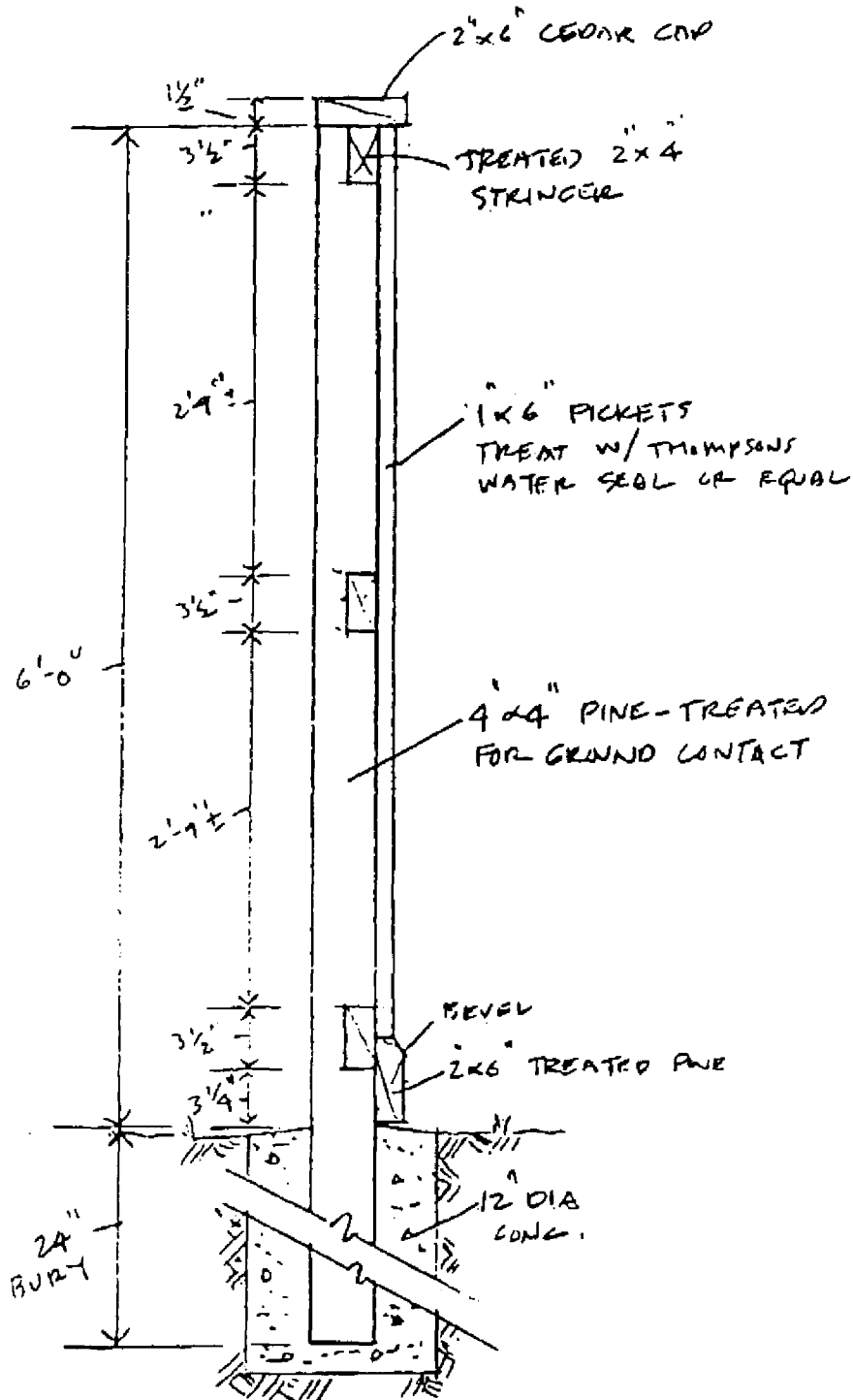

WOOD FENCE
 LANDSCAPE GUIDELINES
 TERANA PLANTATION

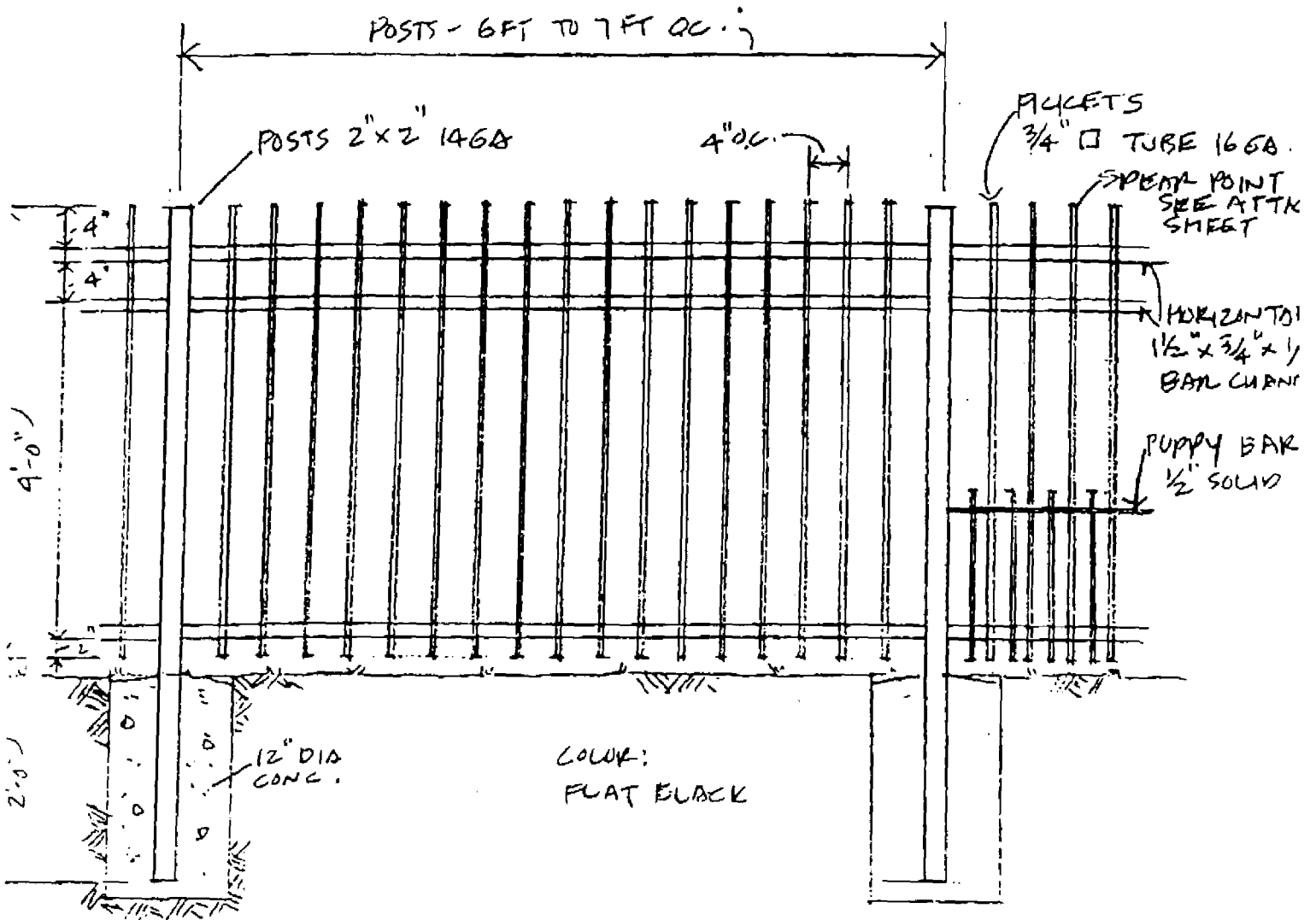

COLOR:
FLAT BLACK

METAL FENCE
LANDSCAPE GUIDELINES
TEXANA PLANTATION

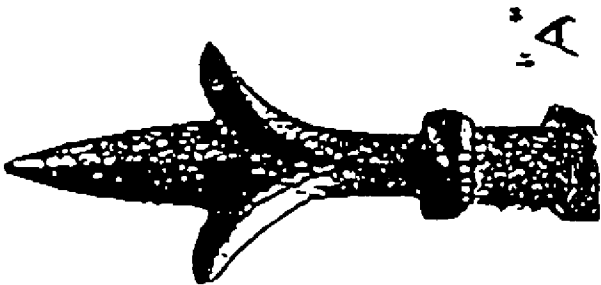
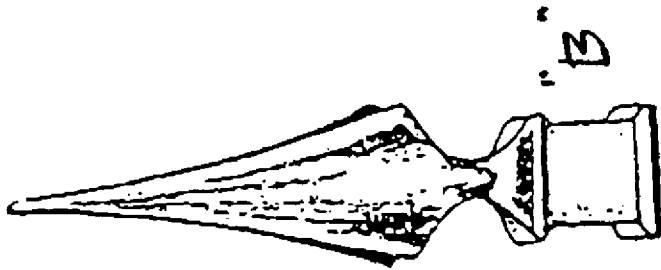
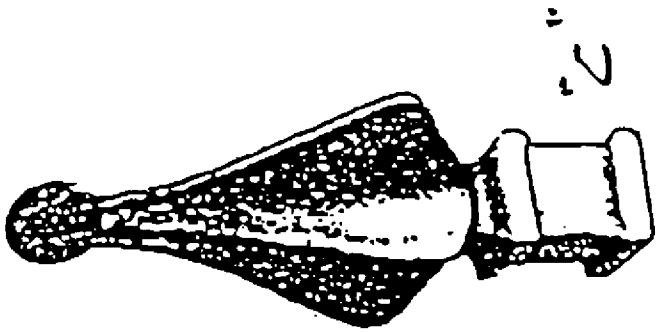

METAL FENCE SPEAR POINTS
LANDSCAPE GUIDELINES
TEXANA PLANTATION